

FRL FPR-1/2"f

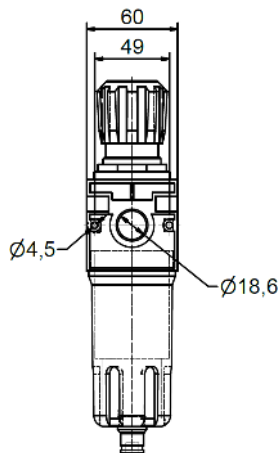

- Combines the technical benefits of the pressure reducer and the water separator with filter in one compact unit
- Pressure regulator with piston for high operational reliability
- Assembly independent of flow direction thanks to double-sided connection option for pressure gauge

- Working pressure range : 0-12 Bar
- Entry pressure: 0-18 bar
- Filter element: 20 µm

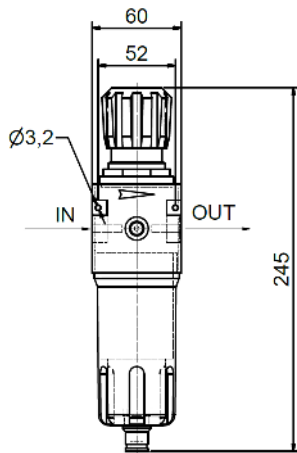

Specifications

Inlet Connection 1/2" Female BSP thread

Outlet Connection 1/2" Female BSP thread

Manometer Connection 1/2" Female BSP thread

Flow rate 2.500 l/min

Condensate tank volume 45 ml

Dimension 60x60x245

Ordering Information

Ordering Information	Weight KG
----------------------	-----------

2813 9200 16	1,114
--------------	-------